

**TESSA NAVETTE SET**  
by Carolyn Cave  
www.ladybeadledesigns.com



**Skill level:** Intermediate

**Techniques:** Circular bead weaving; familiarity with multi-hole beads

**Finished size:** Pendant – 2" (5cm), Earring – 1 3/4" (4cm), Bracelet – 6 3/4" (17cm)

**MATERIALS for all**

7g size 15° seed beads  
3g size 11° seed beads  
14g Ginko beads  
18g Navette beads  
Clasp of choice  
Pair of ear wires

Finished chain  
3 size 5mm jump rings  
D weight beading thread or 6lb. Fireline  
Size 10 or 12 beading needle  
Scissors or thread cutters  
Two pairs of pliers

**COMMENTS**

- This is a component-based design. The pendant is made from a hexagon, the earrings are pentagons, and the bracelet is a set of connected squares. There are many ways to put them together to make new pendants, earrings, bracelets and necklaces. Have fun experimenting with your own designs and configurations.
- Before using multi-hole beads, make sure that the holes are not blocked by excess glass or coating, and that the bead is well-formed.
- When a bead has more than one hole, it is important to know from which direction to pick it up, and through which hole, so that the bead sits correctly in the design. Refer to Figure A for the terms used.

## HEXAGONAL PENDANT

### FIGURE 1

**Step 1.** Cut one yard (90cm) of beading thread. Attach a needle to one end and a stop bead about 2" (5cm) from the other end. Pick up twelve 11° seed beads. Sew through the first two beads picked up, forming a ring.

### FIGURE 2

**Step 2.** Pick up one 15° seed bead, a Ginko bead from the top, one 15°, one 11°, one 15° and a second Ginko from the bottom. Sew through the first Ginko again, in the same direction and through the same hole. Pull the thread snug. Pick up three 15°s, one 11° and three 15°s. Sew through the second unused hole of the first Ginko. Pick up one 15° and sew through the two 11°s on the first ring of beads that were sewn through twice, and the next two 11°s on the ring.

### FIGURE 3

**Step 3.** Repeat the thread path of Step 2, five more times (green, orange, blue, red, gray threads). Keep in mind that some Ginkos and 15°s needed under the Ginko may already be in place from the previous repeat.

**Step 4 (purple thread).** To be in the correct place to start the next round, sew through the first 15° picked up, the Ginko, three 15°s above the Ginko and the 11° at the tip.

### FIGURE 4

**Step 5.** Pick up one 15°, a Navette through an edge hole, four 15°s and one 11°. Sew down through the middle hole of the Navette, the 11° between the two Ginkos, back up through the hole of the Navette and through the last 11° just added, in the same direction. Pull the thread snug. Pick up four 15°s. Sew through the other edge hole of the Navette. Pick up a 15° and sew through the 11° that is at the point of the next Ginko bead (Fig. 4, a-b, orange thread).

**Step 6.** Repeat a-b five more times (Fig. 4, b-c, green thread).

### FIGURE 5

**Step 7.** Sew through the edge hole of the Navette in the direction that the thread is facing, skipping the 15°. Pick up a Ginko bead from the bottom, two 15°s, an 11° and two 15°s. Turn around and sew through the second hole of the Ginko, the edge hole of the Navette on the other side of the Ginko and the 11° that the thread was leaving at the start of this round. Sew through the seed beads below the Navette – four 15°s, an 11° and four 15°s, as well as the 11° at the tip of the next Ginko (Fig. 5, a-b, orange thread). Do not sew through any 15°s between the Navette and Ginkos that were added in the previous step.

**Step 8.** Repeat a-b five more times (Fig. 5, b-c, green thread).

### FIGURE 6

**Step 9.** To make a loop for a bail, follow the thread path through the edge hole of the Navette in the direction that the thread is facing, through the Ginko and through two 15°s. Pick up seven 15°s. Change direction and sew through the 11° at the top of the Ginko as well as the seven 15°s just picked up. Pull the thread snug so a loop of beads forms above the Ginko. Sew through the remaining two 15°s above the Ginko, the second hole of the Ginko and the edge hole of the Navette below. End the thread by sewing through the beadwork following only existing thread paths. Tie a few overhand knots along the way and trim the thread. Undo the stop bead at the start of the work. Attach a needle to the tail thread and finish it off in the same manner as the working thread.

**Step 10.** Use a jump ring to attach to the loop of beads just made and the purchased chain.

**NOTE:** To make a motif without a bail, simply sew through the beadwork following only existing thread paths. Tie a few overhand knots along the way and trim the thread. Undo the stop bead at the start of the work and finish off the thread in the same way.

## PENTAGONAL EARRINGS

### FIGURE 7

**Step 11.** Cut 36" (90cm) of beading thread. Attach a needle to one end and a stop bead about 2" (5cm) from the other end. Pick up five 11°. Sew through the first bead picked up, forming a ring.

### FIGURE 8

**Step 12.** Pick up one 15°, a Ginko from the top, two 15°, one 11°, two 15°s and a second Ginko from the bottom. Sew through the first Ginko again, in the same direction and through the same hole. Pull the thread snug. Pick up three 15°s, one 11° and three 15°s. Sew through the second unused hole of the first Ginko. Pick up one 15° and sew through the 11° on the first ring of beads that was sewn through twice and the next 11° on the ring.

### FIGURE 9

**Step 13.** Repeat the thread path of Step 12, four more times (Fig. 9, **red, green, orange, blue** threads). Keep in mind that some Ginkos and 15°s needed under the Ginko may already be in place from the previous repeat. To be in the correct place to start the next round, sew through the first 15° picked up, the Ginko, three 15°s above the Ginko and the 11° at the tip (Fig. 9, **pink thread**).

### FIGURE 10

**Step 14 (orange thread).** Pick up one 15°, a Navette through an edge hole, four 15°s, one 11° and four 15°s. Sew through the other edge hole of the Navette. Pick up an 11°. Heading towards the place where the thread started this round, sew through four 15°s above the Ginkos, the 11° between the Ginkos and the next four 15°s. Pick up an 11°. Pull the thread snug. Follow the thread path just taken, through the first edge hole of the Navette, four 15°s, 11°, four 15°s and second edge hole of the Navette. Pick up a 15° and sew through the 11° at the tip of the next Ginko moving forwards.

**Step 15.** Repeat **a-b** four more times, ending back where this round began. To be in the correct place to start the next round, sew through the first 15° picked up and the edge hole of the first Navette (Fig. 10, **b-c, green thread**).

### FIGURE 11

**Step 16.** Change the direction of stitching in this round. Pick up three 15°s, a Ginko from the bottom, one 11°, five 15°s and one 11°. Sew through the unused hole of the Ginko, from the top. Pick up three 15°s. Sew through the four 15°s, 11° and four 15°s along the top of the next Navette (Fig. 11, **a-b, orange thread**).

**OPTION 1:** No Ginkos along the edge (as shown in the Photo)

- Sew down through the edge hole of the Navette, the 15° below it, the 11° at the top of the Ginko underneath, the 15° below the next Navette, the edge hole of that Navette and the four 15°s, 11° and four 15°s along the top of the Navette (Fig. 11, **b-c, green thread**).
- Repeat **b-c** three more times around the work (Fig. 11, **c, blue thread**). Follow the thread path through the first Ginko added, to strengthen the loop. Continue along the edge for as long as the thread will allow. Tie a few overhand knots along the way and trim the thread.

**OPTION 2:** Ginkos along the edge, to match the Pendant

- Pick up three 15°s, one Ginko from the bottom, two 15°s, one 11° and two 15°s. Sew through the unused hole of the Ginko, from the top. Pick up three 15°s. Sew through the four 15°s, 11° and four 15°s along the top of the Navette (Fig. 11, **d-e, pink thread**).
- Repeat **d-e** three more times around the work (Fig. 11, **e, gray thread**). Follow the thread path through the first Ginko added, to strengthen the loop. Continue along the edge for as long as the thread will allow. Tie a few overhand knots along the way and trim the thread. **NOTE:** The Ginkos around the edge will be a bit floppy.

**Step 17.** Open the loop on one ear wire using two pairs of pliers. Slip the opened loop through the loop of beads at the top of the earring. Close the metal loop. Make a second earring.

Please respect my designs by not reselling or altering my patterns in any way. Do not replace or modify text, images, names, logos, or URLs. Feel free to recreate this design for personal use and limited sales but not for mass production. Permission to tech this pattern is exclusive to customers of The BeadSmith.

## SQUARE BRACELET

### FIGURE 12 – First Square

**Step 18.** Cut 24" (60cm) of beading thread and attach a needle to one end. Pick up four size 15°. Sew through all of the beads again. Slide the bead towards the end of the thread leaving a short tail for weaving in later. Pull the thread snug and sew through the first bead for a third time.

**Step 19.** Pick up a Ginko from the top, one size 11°, a Navette through an edge hole, four 15°, one 11° and four 15°. Sew through the second edge hole of the Navette. Pick up an 11°, a Ginko from the bottom and a 15°. Sew through the first Ginko picked up, through the same hole and in the same direction, and the next 11°. Pull the thread snug (Fig. 13, a-b, **red thread**).

**Step 20.** Pick up one 11°, one 15° and two 11°. Sew through the unused hole of the first Ginko, from the bottom, and the 15° on the initial ring of beads that the thread was leaving, in the same direction. Pick up a 15° and sew through the next 15° on the initial ring of beads (Fig. 13, b-c, **green thread**).

### FIGURE 14

**Step 21.** Repeat the thread path of Step 19 three more times (Fig. 14, a-b, **red, green, orange** threads). To be in the correct place to start the next round, sew through the first Ginko added in this round, from the top, and the next two 11°s (Fig. 14, b-c, **blue thread**).

### FIGURE 15

**Step 22.** Sew around the outside edge of the square motif, through the edge holes of the Navettes, the seed beads above them and the 11°, 15° and 11° seed beads above the tip of the Ginkos. Sew until the thread exits the second edge hole of the third Navette (Figure 15, a-b, **green thread**).

### MAKE A LOOP FOR THE CLASP

**Step 23.** Pick up seven 15°. Turn around and sew through the 11°, 15° and 11° above the Ginko in the opposite way the rest of the round was stitched. Sew again through the seven 15°s just picked up and the edge hole of the next Navette (Fig. 15, b-c, **blue thread**). Pull the thread snug. Resume sewing around the outside edge of the square. Sew past the place where this round began (Fig. 15, c, **orange thread**). Continue sewing, adding an overhand knot in front of a large-holed bead every now and then. Trim the thread.

### FIGURE 16 – Second Square

**Step 23.** Cut 60 cm (24 inches) of beading thread and attach a needle to one end. Stitch Step 18.

**Step 24.** Pick up a Ginko from the top, one 11°, a Navette through an edge hole, four 15°, one 11° and two 15°. Align the first square next to the current work with the clasp loop on the left. Sew through the two 15°s closest to the edge hole on the completed square that correspond to the two that would have been picked up to complete the upper portion embellishment of this Navette. Sew through the second edge hole of the Navette. Pick up an 11°, a Ginko from the bottom and a 15°. Sew through the first Ginko picked up, through the same hole and in the same direction, and the next 11°. Pull the thread snug (Fig. 16, a-b, **red thread**).

**Step 25.** Pick up one 11°, one 15° and two 11°. Sew through the unused hole of the first Ginko, from the bottom and the 15° on the initial ring of beads that the thread was leaving, in the same direction. Pick up a 15° and sew through the next 15° on the initial ring of beads (Fig. 16, b-c, **green thread**).

### FIGURE 17

**Step 26.** Sew through the second Ginko from the top. Pick up one 11° and a Navette through an edge hole. Sew through the first two 15°s above the corresponding mirror image Navette on the completed square. Pick up two 15°s, one 11° and four 15°. Sew through the second edge hole of the Navette. Pick up an 11°, a Ginko from the bottom and a 15°. Sew through the first Ginko used, through the same hole and in the same direction and the next 11°. Pull the thread snug. Complete the remainder of Step 24 (Fig. 17, a-b, **red thread**).

**Step 27.** Repeat the thread path of Step 19 two more times (Fig. 17, b-c, **green, orange** threads). To be in the correct place to start the next round, sew through the first Ginko added in this round, from the top, and the next two 11°s (Fig. 14, c-d, **blue thread**).

#### **FIGURE 18**

**Step 28.** Sew around the outside edge of the square motif, through the edge holes of the Navettes, the seed beads above them and the 11°, 15° and 11° seed beads above the tip of the Ginkos. Sew until the thread exits the second edge hole of the third Navette (Fig. 18, a-b, **green thread**).

#### **JOIN THE TWO MOTIFS**

**Step 29.** Sew through the first 11° and next 15° above the Ginko. Pick up an 11°. Sew through the 15° above the Ginko in the completed motif, in the opposite direction to the direction of the round. Pick up an 11°. Sew through the 15° above the Ginko that you are working on, the 11° beside it and the edge hole of the next Navette (Fig. 18, b-c, **blue thread**). Pull the thread snug. Resume sewing around the outside edge of the square. Sew past the place where this round began (Fig. 18, c, **orange thread**). Continue sewing, adding an overhand knot in front of a large-holed bead every now and then. Trim the thread.

**Step 30.** Make four more squares and attach them to each other as you did the first two. Make a seventh square attached to the previous ones, as before, but remember to stitch a clasp loop in the last round above the Ginko at the far end of the bracelet (refer to Step 22).

**Step 31.** Open a jump ring with two pairs of pliers. Slip the open jump ring onto one of the clasp loops. Add one half of the clasp and close the jump ring. Repeat with the second jump ring at the other end of the bracelet using the remaining half of the clasp.



● size 11/0 seed bead

● size 15/0 rocaille

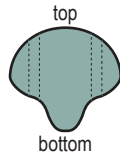

Figure A

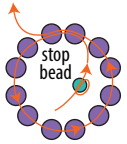

Figure 1

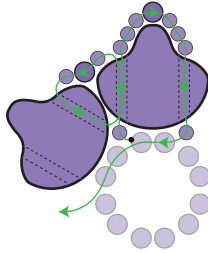

Figure 2

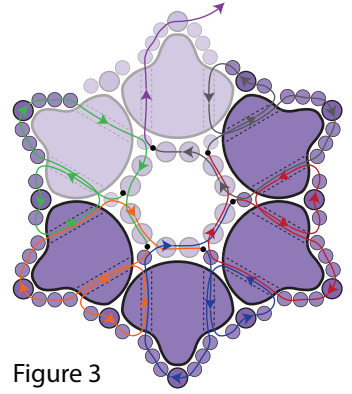

Figure 3

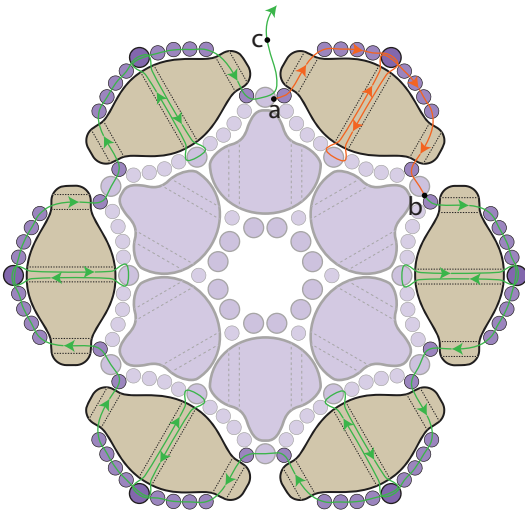

Figure 4

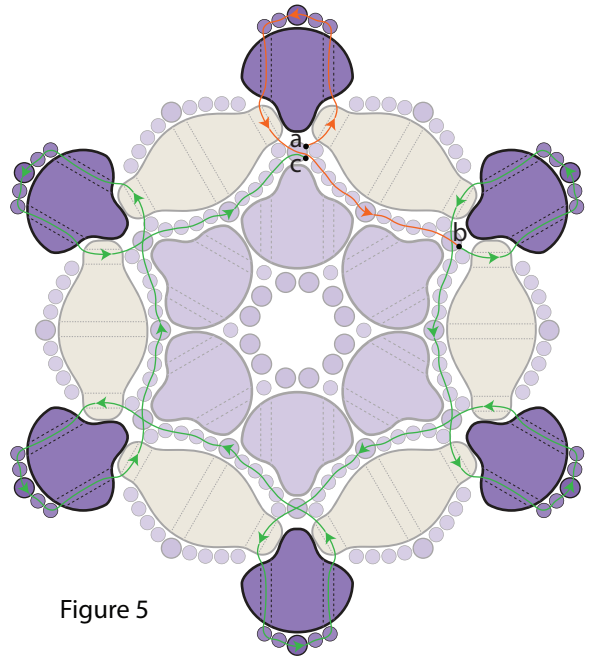

Figure 5

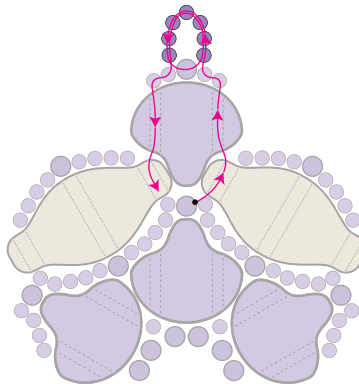

Figure 6

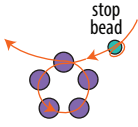

Figure 7

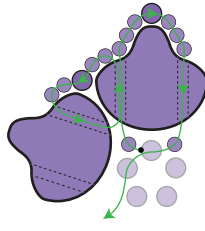

Figure 8

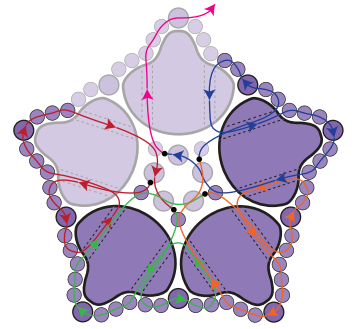

Figure 9

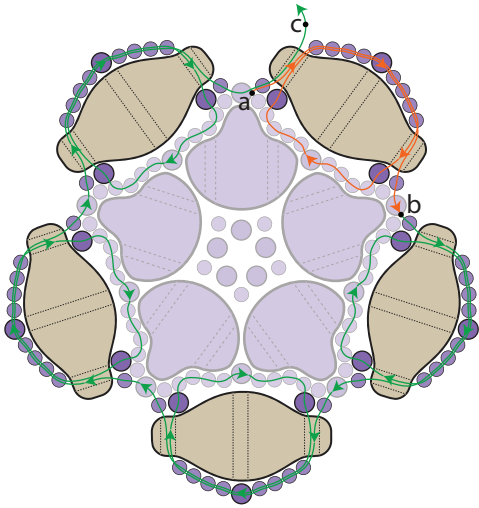

Figure 10

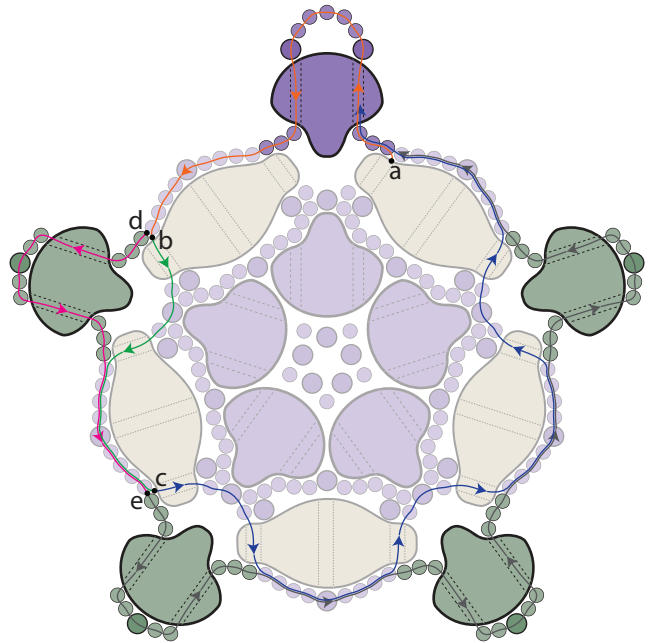

Figure 11



Figure 12

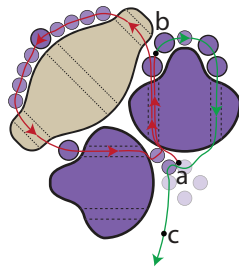

Figure 13

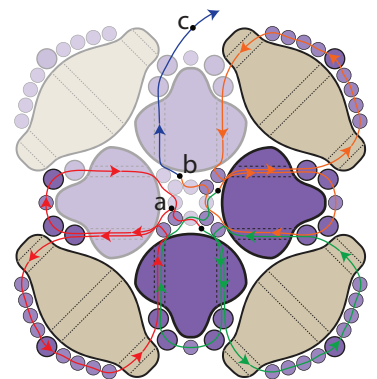

Figure 14

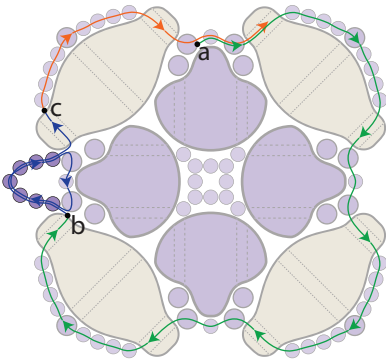

Figure 15

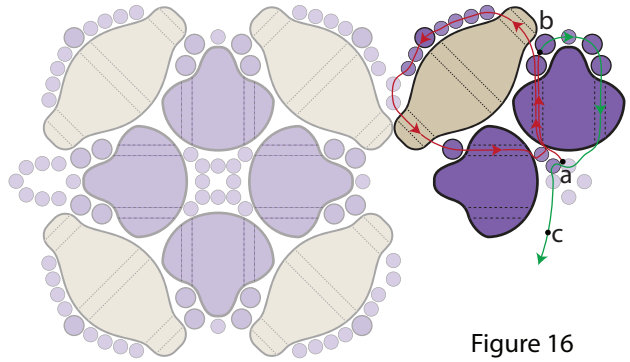

Figure 16

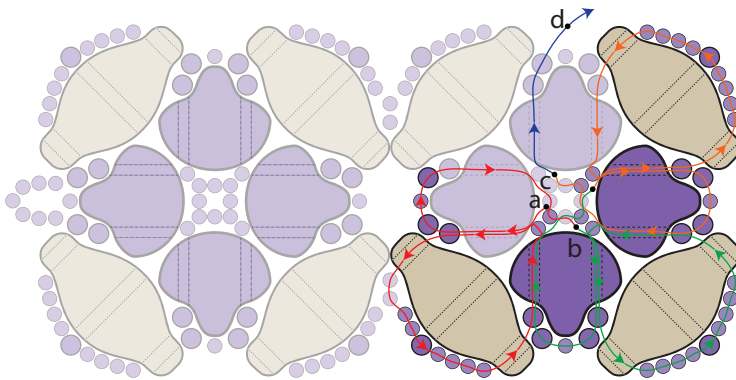

Figure 17

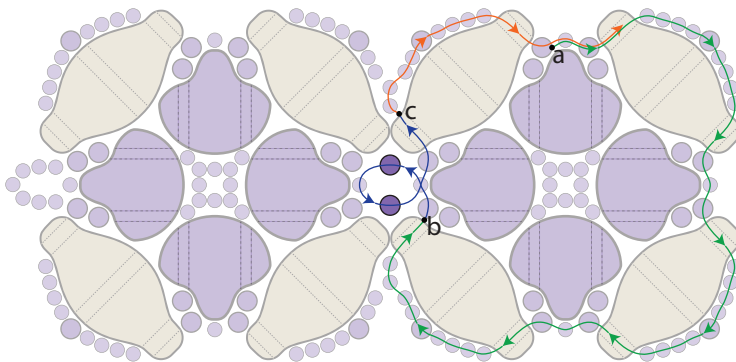

Figure 18